

Instructions

Item	Specifications
Slide hammer	1.6kg, 160 mm
Slide hammer	2.7kg, 460 mm
Slide hammer	5.1kg, 600 mm
Pulling claw	13.7 x 18 mm, 105 mm long
Pulling claw	12.7 x 19 mm, 130 mm long
Slotted socket 1/2"	25, 27, 28, 29, 30 mm
Pulling adapter	Internal thread M27 x 1.0 (x3), M25 x 1
Pulling adapter	External thread M27 x 1.0 (x3)
Hammer adapter	For all adapters

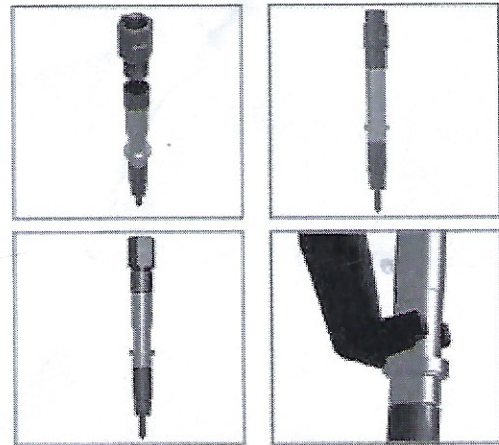

EXTERNAL ADAPTOR INSTRUCTIONS

- 1) Remove the electrical parts before positioning the adapter.
- 2) Position the adapter along with the outside thread on top of the injector.
- 3) Then attach the slide hammer onto the adapter & injector.
- 4) With slight pressure bring the slide hammer upwards to remove the injector.
- 5) Once removal of the injector is completed, replace with a new or refurbished injector.

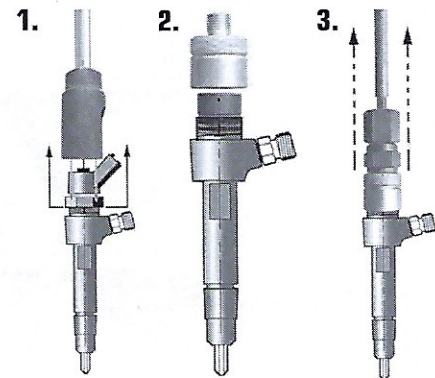

INTERNAL ADAPTOR INSTRUCTIONS

- 1) Remove the electrical parts
- 2) Use a hex socket by turning anti-clockwise to remove the inside sleeve
- 3) With the correct internal adaptor screw into the threads of the injector.
- 4) Fit the slide hammer onto the adaptor.
- 5) Now remove the injector with pressure onto the slide hammer.
- 6) The injector will now come away from the injector of the cylinder head.
- 7) When an injector has been removed, it is recommended that only a new or refurbished injector is fitted.

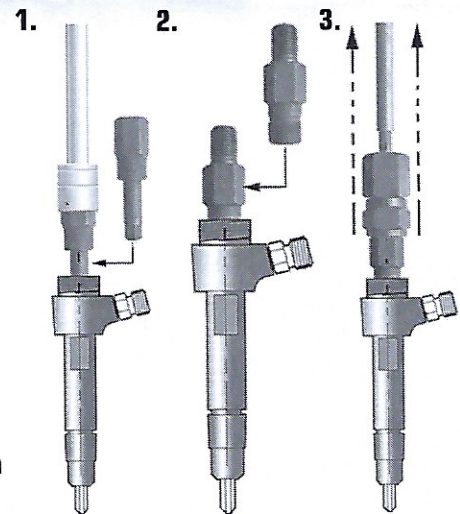

Warranty

If you are unsure on how to use the item please contact us. If it were to fail due to a manufacturing fault or poor workmanship we will repair or replace it. Please contact your local dealer in the event you need to send the item back. You can also make a repair/replacement request on our website and download & complete the form online. Normal wear and tear along with misuse will void any warranty. Consumables are not covered under warranty.

www.welzh.com

Limited **12 month** warranty



Welzh Werkzeug Ltd
1 - 6 the Green
Eastriggs
DG12 6NH
+44 (0)1461 700120